

JAX STATE
Jacksonville State University



**COLLEGE OF EDUCATION & PROFESSIONAL STUDIES
NAMING OPPORTUNITIES**

COLLEGE OF EDUCATION & PROFESSIONAL STUDIES

The Jacksonville State University, College of Education & Professional Studies (CEPS) proudly serves the citizens of northeast Alabama, the southeast and the nation through our traditional and online programs. The CEPS has over 17,600 proud alumni at the undergraduate and graduate level. Teachers and other school personnel prepare at the baccalaureate, master's, educational specialist and doctoral levels, develop an extensive knowledge and skill-based education appropriate for the level of certification. Developing initial and advanced educational candidates into effective, reflective, creative decision makers is the fundamental goal of all teacher preparation programs at the University. Each degree program is designed to provide a strong knowledge and skill base that will help to ensure a successful future.

There are three departments within the College:

- **Career Technical Education and Professional Studies** (formerly Family and Consumer Science)
- **Teacher Education** (formerly Curriculum & Instruction and Secondary Education)
- **Professional Counseling and Leadership** (formerly Counseling and Instructional Support)

CEPS envisions itself as a hub of teaching and learning that couples its long-standing tradition of producing highly qualified professionals with a spirit of collaboration and innovation to attract, prepare and retain candidates prepared for today's stakeholders and workplaces. Through the lens of continuous program improvement, candidate engagement, shared governance and strategic initiatives, we are laser focused on graduating individuals from programs of study that prepare them to make a positive impact, become effective leaders within a diverse community and make significant contributions that improve their fields.

In the summer of 2023, CEPS relocated from its long-time home at Ramona Woods Hall to the former Kitty Stone Elementary, which has been transformed into a state-of-the-art training center.



BUILDING - HALL (Naming) | \$15M

COLLEGE (Naming) | \$15M

DEPARTMENTS (Naming) | \$1M

- Career Technical Education and Professional Studies Programs
- Teacher Education Programs
- Professional Counseling and Leadership Programs

COLLEGE OF EDUCATION & PROFESSIONAL STUDIES



DEAN'S SUITE OFFICE



DEAN'S LARGE CONFERENCE ROOM



1ST FLOOR OFFICE



1ST FLOOR CLASSROOM

COLLEGE OF EDUCATION & PROFESSIONAL STUDIES



2ND FLOOR OFFICE



2ND FLOOR CLASSROOM



2ND FLOOR CLASSROOM

COLLEGE OF EDUCATION & PROFESSIONAL STUDIES



POD 6 OFFICE



POD 6 OFFICE



POD 1 COMMON AREA



POD 1 CONFERENCE ROOM

COLLEGE OF EDUCATION & PROFESSIONAL STUDIES



KITCHEN LAB



KITCHEN LAB



COUNSELING LAB



**FASHION MERCHANDISING
CLASSROOM**

COLLEGE OF EDUCATION & PROFESSIONAL STUDIES



EARLY CHILDHOOD DEV
CLASSROOM -POD 4



LEARNING DEVELOPMENT
CENTER -POD 4



LEARNING DEVELOPMENT
CENTER -POD 4



PLAYGROUND

COLLEGE OF EDUCATION & PROFESSIONAL STUDIES



STUDENT COMMONS

NAMING OPPORTUNITIES



■ Associate Dean's Office	\$25K
■ Associate Dean's Office Admin	\$10K
■ College Conference Room	\$25K
■ Professional Counseling and Leadership Dept.	\$250K
■ First Floor Offices (5)	\$10K
■ Conference Room	\$25K
■ Counseling Lab	\$25K
■ COEPS Courtyard	\$100K

1ST FLOOR

■ 1st Floor Classrooms - 115/121/122	\$35K
■ Computer Lab	\$50K
■ 1st Floor Classroom 120	\$100K
■ Student Commons 123	\$150K
■ 1st Floor Classroom 124	\$75K
■ Commercial Kitchen 125	\$75K
■ Dean's Suite	\$100K
■ Dean's Office	\$25K
■ Dean's Admin Office	\$10K
■ Dean's Conference Room	\$10K

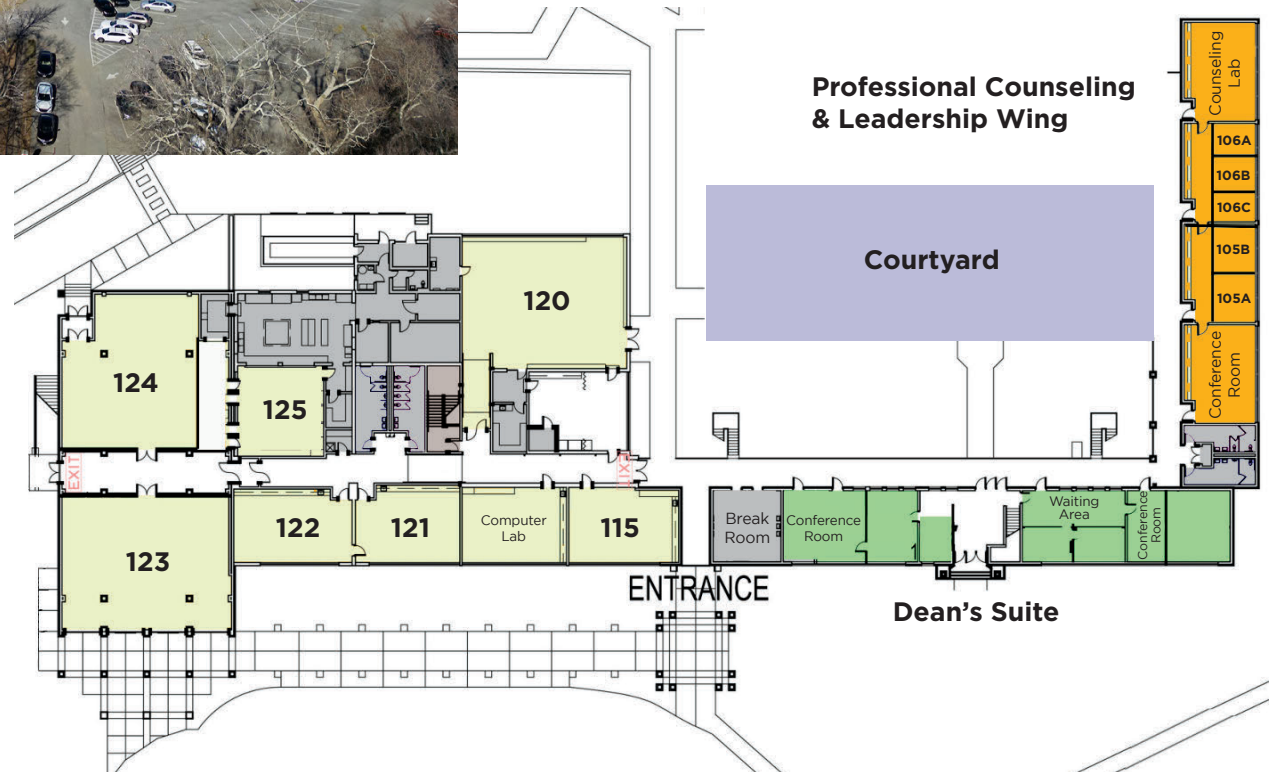

NAMING OPPORTUNITIES

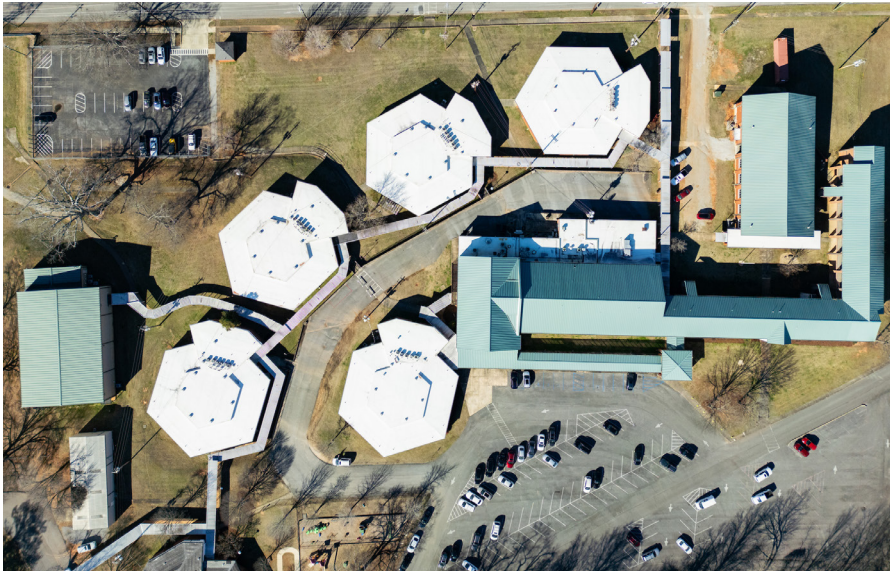

2ND FLOOR

- 2nd Floor Classrooms (6)- 208/209/211/212/214/216 **\$35K**
- 2nd Floor Classrooms (8)- 215/217-223 **\$50K**
- 2nd Floor Offices (9) **\$10K**
- Conference Room **\$25K**

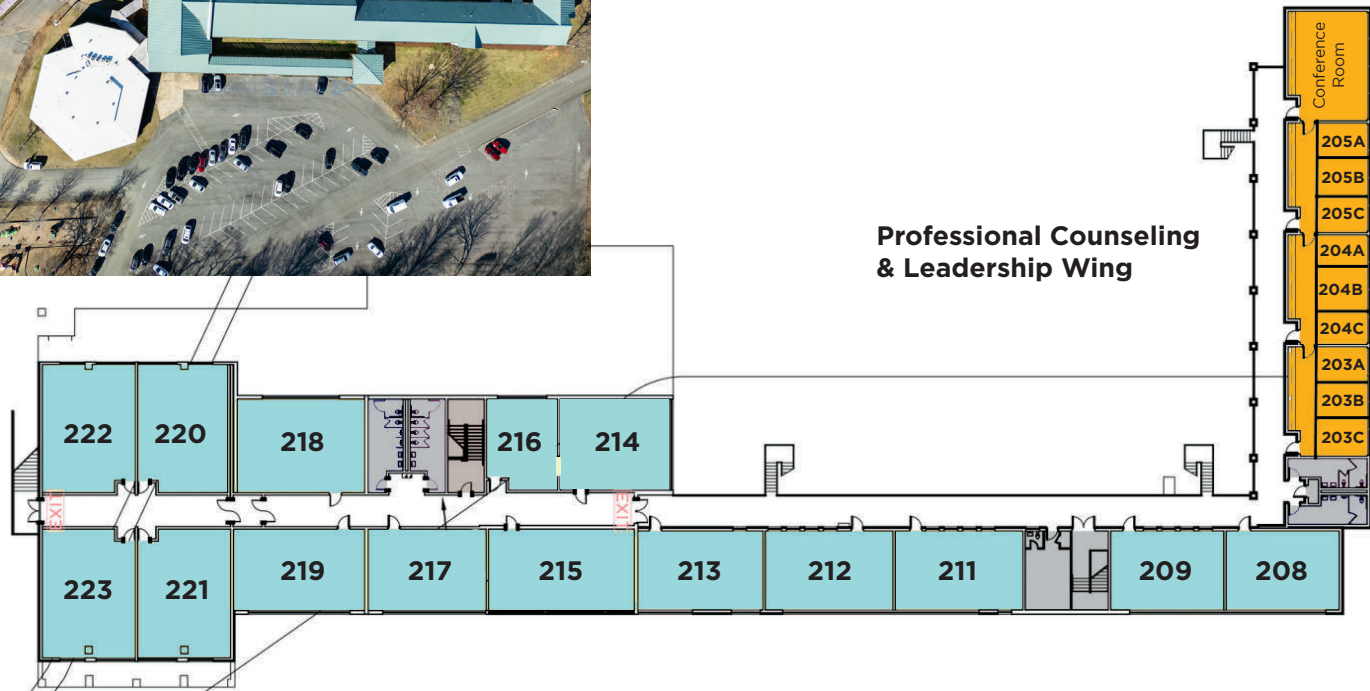

NAMING OPPORTUNITIES

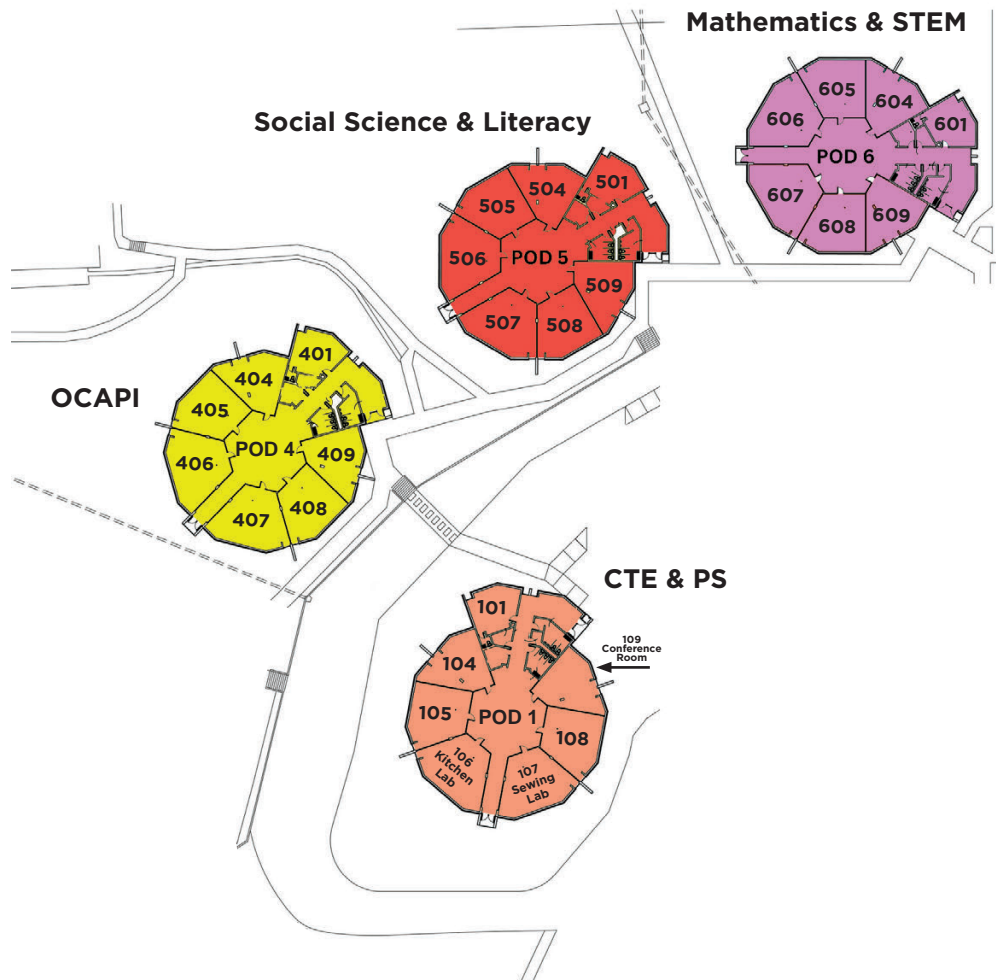

PODS 1/4/5/6





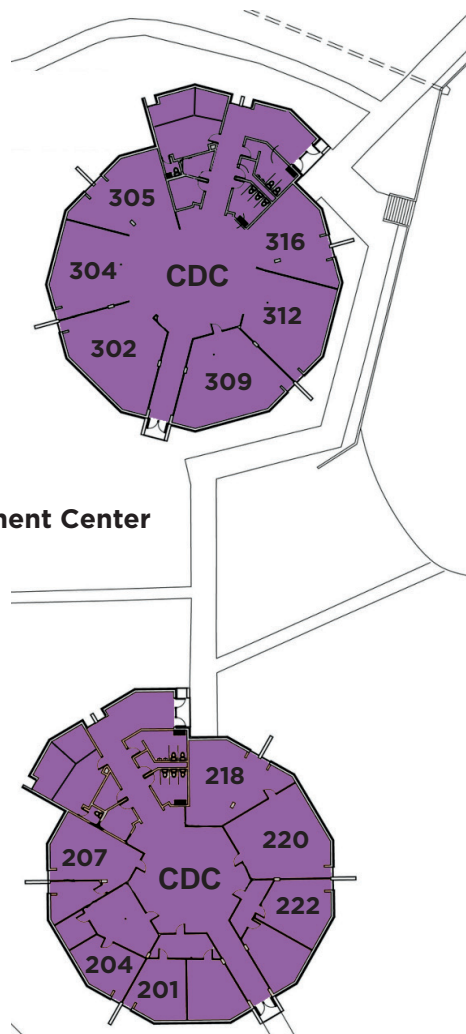



 Mathematics & Stem Dept. - Pod 6	\$250K
 Offices 601, 605-608 (5)	\$25K
 Faculty Workroom 604	\$25K
 Maker Space 609	\$25K
 Social Science & Literacy - Pod 5	\$250K
 Offices 501, 505-508 (5)	\$25K
 Faculty Workroom 504	\$25K
 Model Classroom 509	\$25K
 Office of Accreditation, Certification and Partnership Initiative (OCAPI) - Pod 4	\$250K
 Offices 401, 405, 406, 409 (4)	\$25K
 Faculty Workroom 404	\$25K
 Children's Library 407	\$25K
 Learning Resource Center 408	\$25K
 Career Technical Education and Professional Studies (CTE & PS) - Pod 1	\$250K
 Offices 101, 104, 105, 108 (4)	\$25K
 Faculty Workroom 104	\$25K
 Conference Room 109	\$25K
 Kitchen Lab 106	\$25K
 Sewing Lab 107	\$25K

NAMING OPPORTUNITIES



Child Development Center

CDC PODS 2/3

	Child Development Center (CDC) Facilities	\$1M
	CDC - Pod 1 (K-2)	\$250K
	Offices - 212-213	\$10K
	Faculty Workroom 207	\$25K
	Classrooms 201/204/218/220/222	\$25K
	CDC - Pod 2 (3-4)	\$250K
	Offices - 310-311	\$10K
	Faculty Workroom 305	\$25K
	Classrooms 302/304/309/312/316	\$25K

